

## Routes affected by partial revocation of A303 Trunk Road (Sparkford to Ilchester Improvement and Slip Roads) (Side Roads) Order 1996

ID	Path	1996 SRO	2018/9 DCO	DCO Red line	Issue arising from partial revocation?
1	Y30/29 (not on Definitive Map!) & 1996 SRO Plan 1 'A' (Sch 1)	New bridleway	N/A	Part in, part out	Potentially. If the rights have been created then the effect of the DCO would be to leave two cul-de-sac bridleways.
2	Y 27/21	Wholly stopped up	Wholly stopped up (Sheet 2 of 4 Inset D)	Part in, part out	No, as DCO stops up all of it.
3	1996 SRO Plan 2 'E' (Sch 1&2)	New bridleway	N/A	Part in, part out	Potentially. If the rights have been created then the effect of the DCO would be to leave two cul-de-sac bridleways.
4	WN 23/33 & 1996 SRO Plan 2 'F' Sch 1 & 2	Part stopped up and new footpath	Part stopping up (Sheet 3 of 4 Inset G)	Part in, part out (particularly affected by construction road)	Potentially. If the rights have been created then the effect of the DCO would be to create a number of cul-de-sac/ island sections of footpath.
5	1996 SRO Plan 2 'G' (Sch 1&2)	New bridleway	Part stopping up WN 23/10 (Sheet 3 of 4 Inset G)	Part in, part out	Potentially. If the rights have been created then the effect of the DCO would be to leave two cul-de-sac bridleways and could and possible impacts on WN 23/10.

# Photographic extracts of each issue by above ID reference

1

1996 SRO

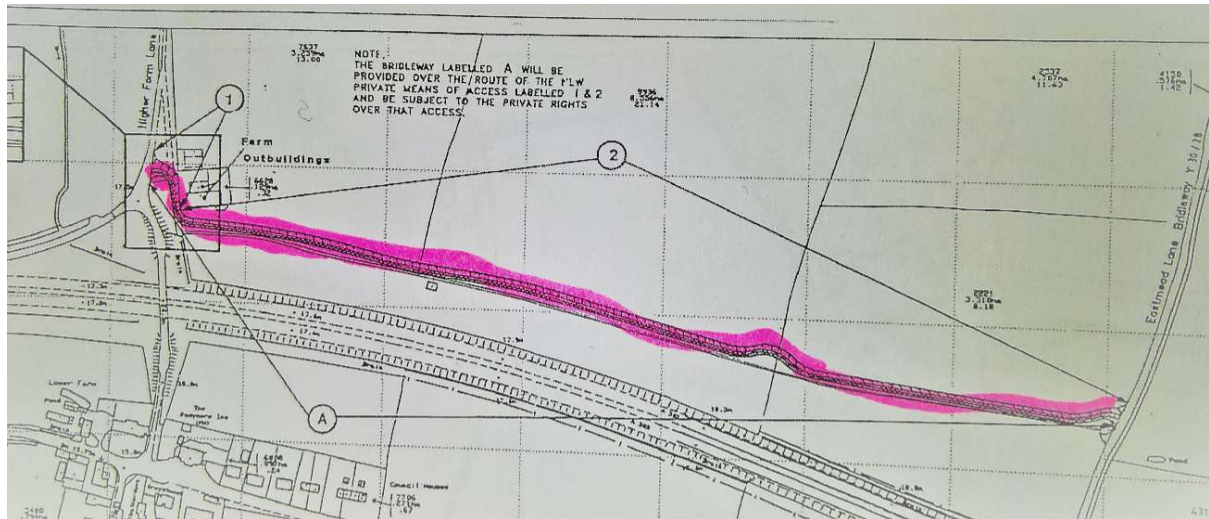

2018/19 DCO



2

1996 SRO

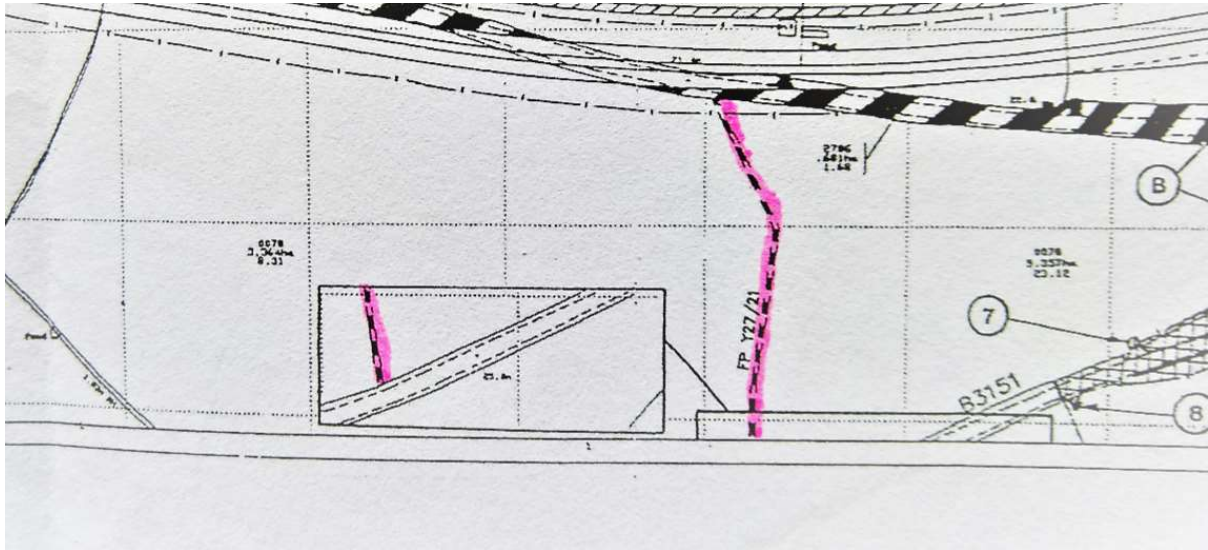

2018/19 DCO

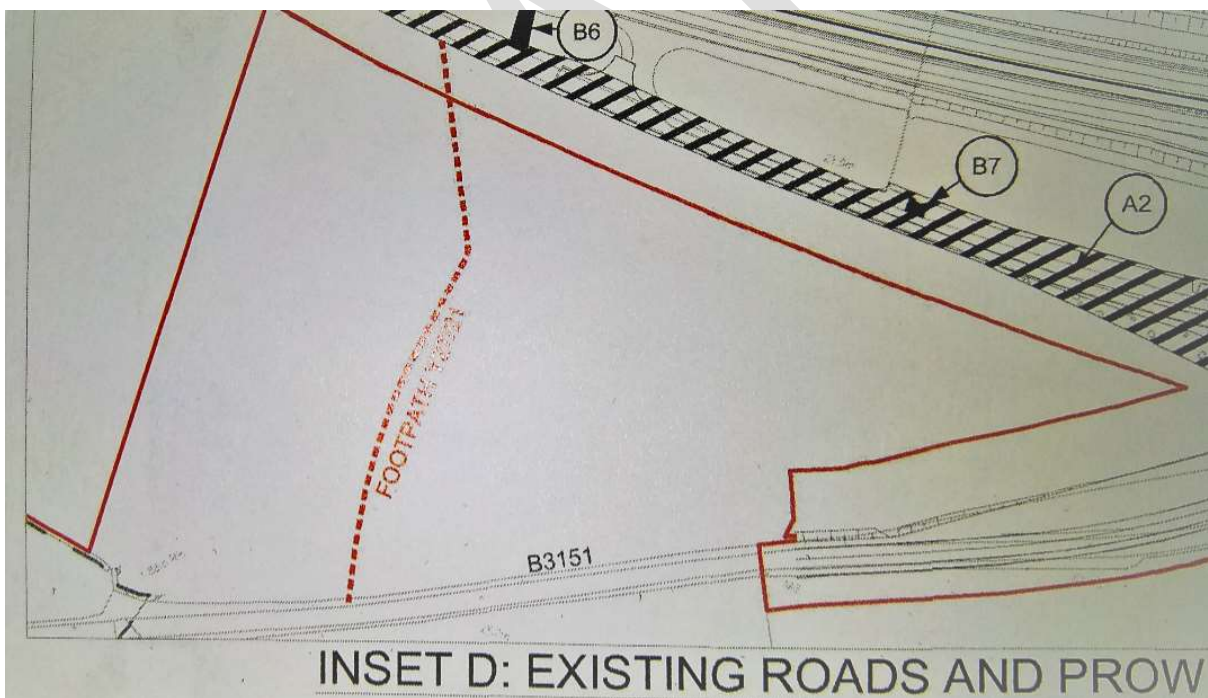



## 1996 SRO

